



1 Seymour Street Fingal TAS

4 🏠 2 🚗

As you drive towards the quaint historic township of Fingal, you pass some of the most spectacular countryside in Tasmania. Here you are at the foothills of the spectacular Ben Lomond and its towering 600m dolerite, quartzite, and granite cliffs. The Manse is positioned on a high knoll overlooking the township with spectacular views over the Fingal valley and mountain range. Built in c.1920, this was home to the Minister of the neighbouring Presbyterian Church built in the Carpenter Gothic style in 1881, before it became the Uniting Church. Today it is a private residence but also suitable as a tourism venture, weekend country escape, or long-term rental investment.

In 1827, William Talbot, an Irishman born in Malahide Castle, in County Fingal, was granted land in the district

Type : House
Building Size : 148 sqm
Land Size : 2700 sqm
View : <https://www.historicproperty.com.au/8314969>



Dominic Romeo
0438 500 277

[For full version visit the website](https://www.historicproperty.com.au)

THE MANSE, FINGAL TAS

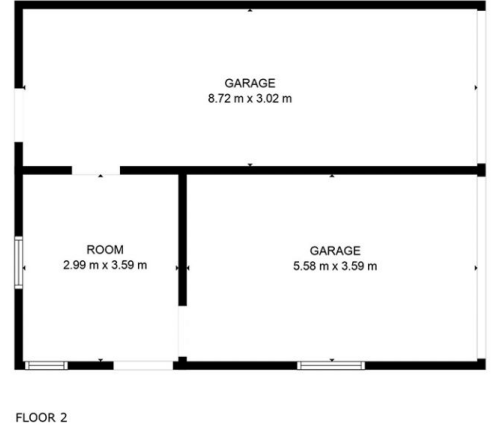
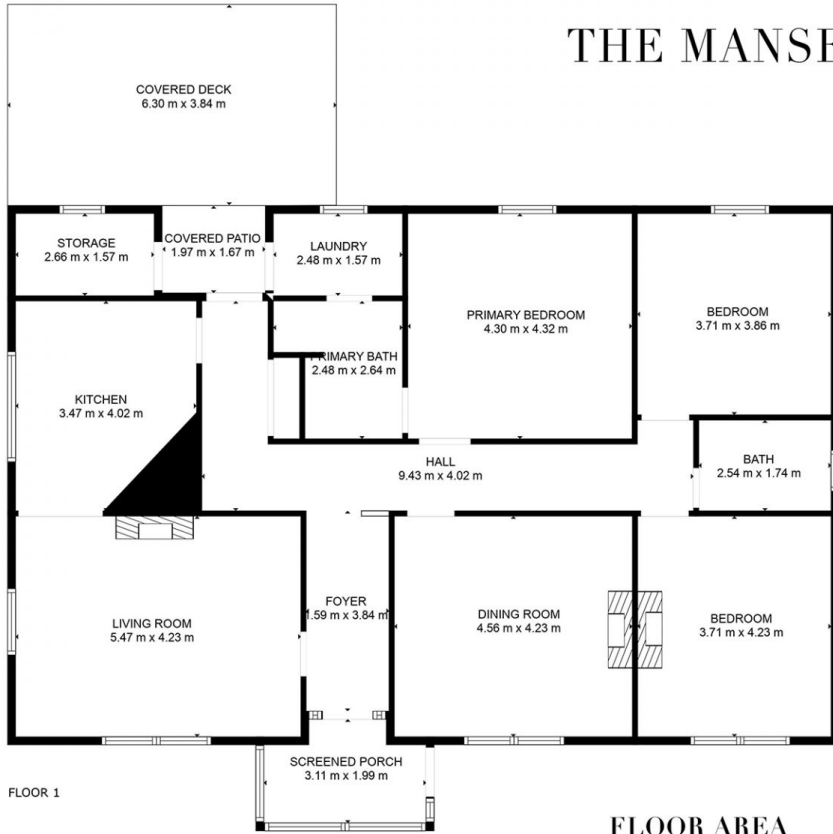

FLOOR AREA
House : 148 m²
Garage : 46 m²

